

ASSEMBLY INSTRUCTIONS

CISCO TIMBER BED BASE KING

Please read instructions carefully. Remove all wrapping material, staples and packing straps from the carton. See hardware and furniture parts list for guidance. Be sure you have all parts before you start assembling. Place all wooden furniture parts on a clean flat soft surface, such as carpet or rug to prevent from being scratched.

PARTS INCLUDED

- | | |
|----------------------|--------|
| 1. Head / Foot board | : 2pcs |
| 2. Side board | : 2pcs |
| 3. Rail | : 1pc |
| 4. Leg | : 4pcs |
| 5. Metal support | : 2pcs |
| 6. Metal leg | : 4pcs |

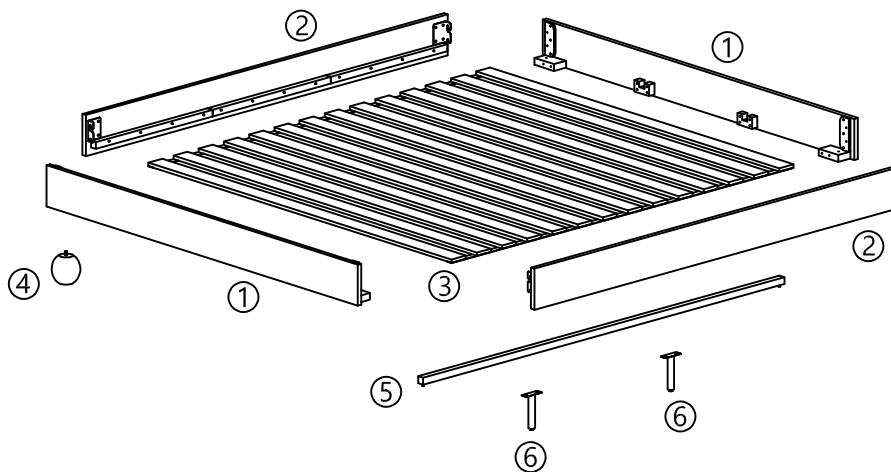

HARDWARE LIST

- | | |
|------------------|--------|
| A. Bolt | : 8pcs |
| B. Allen key | : 1pc |
| C. Bolt | : 8pcs |
| D. Spring washer | : 8pcs |
| E. Flat washer | : 8pcs |

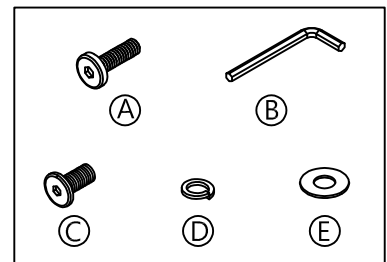
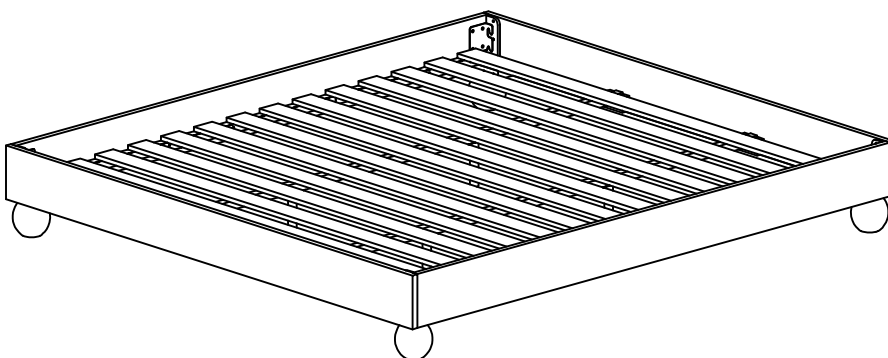

ASSEMBLY INSTRUCTIONS

CISCO TIMBER BED BASE KING

adairs

STEP 1

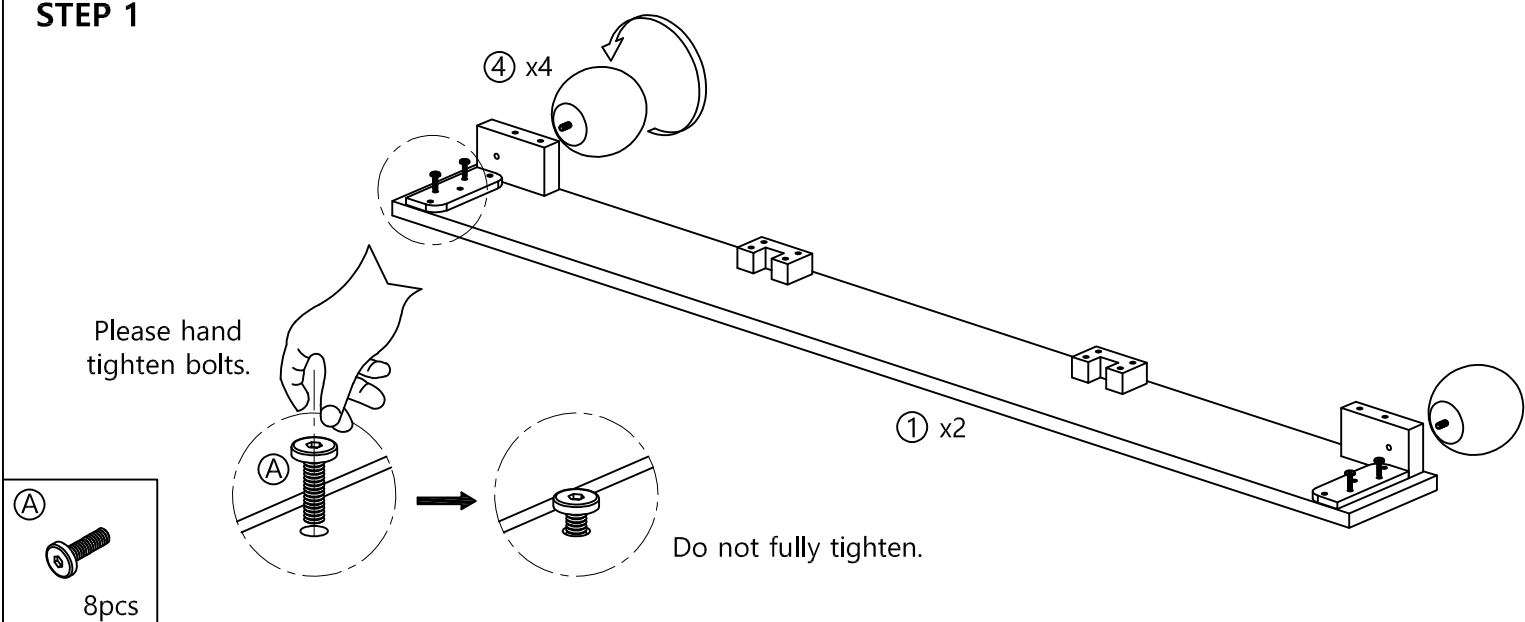

STEP 2

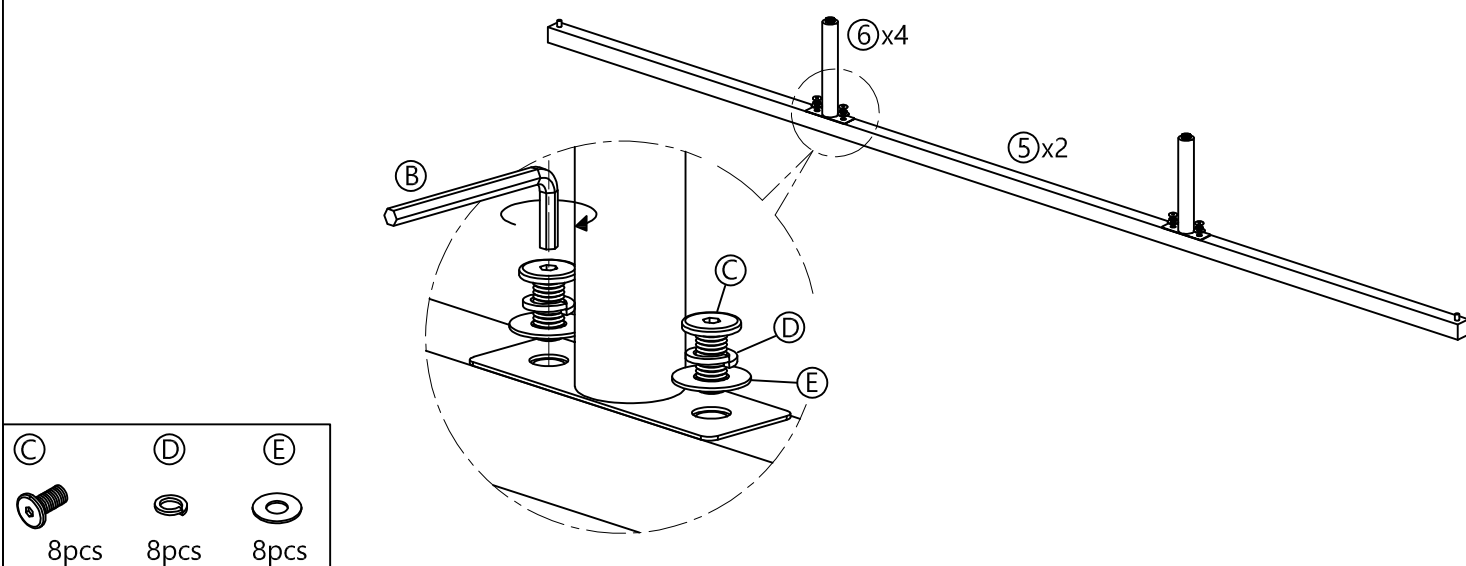

STEP 3

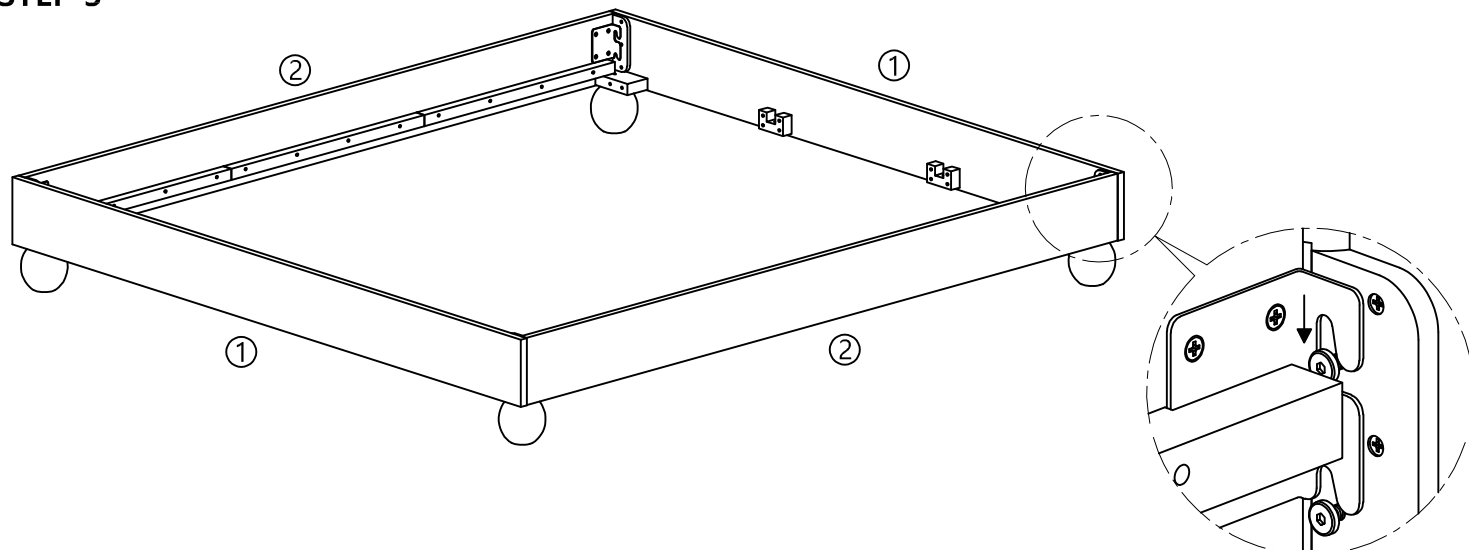

ASSEMBLY INSTRUCTIONS

CISCO TIMBER BED BASE KING

adairs

STEP 4

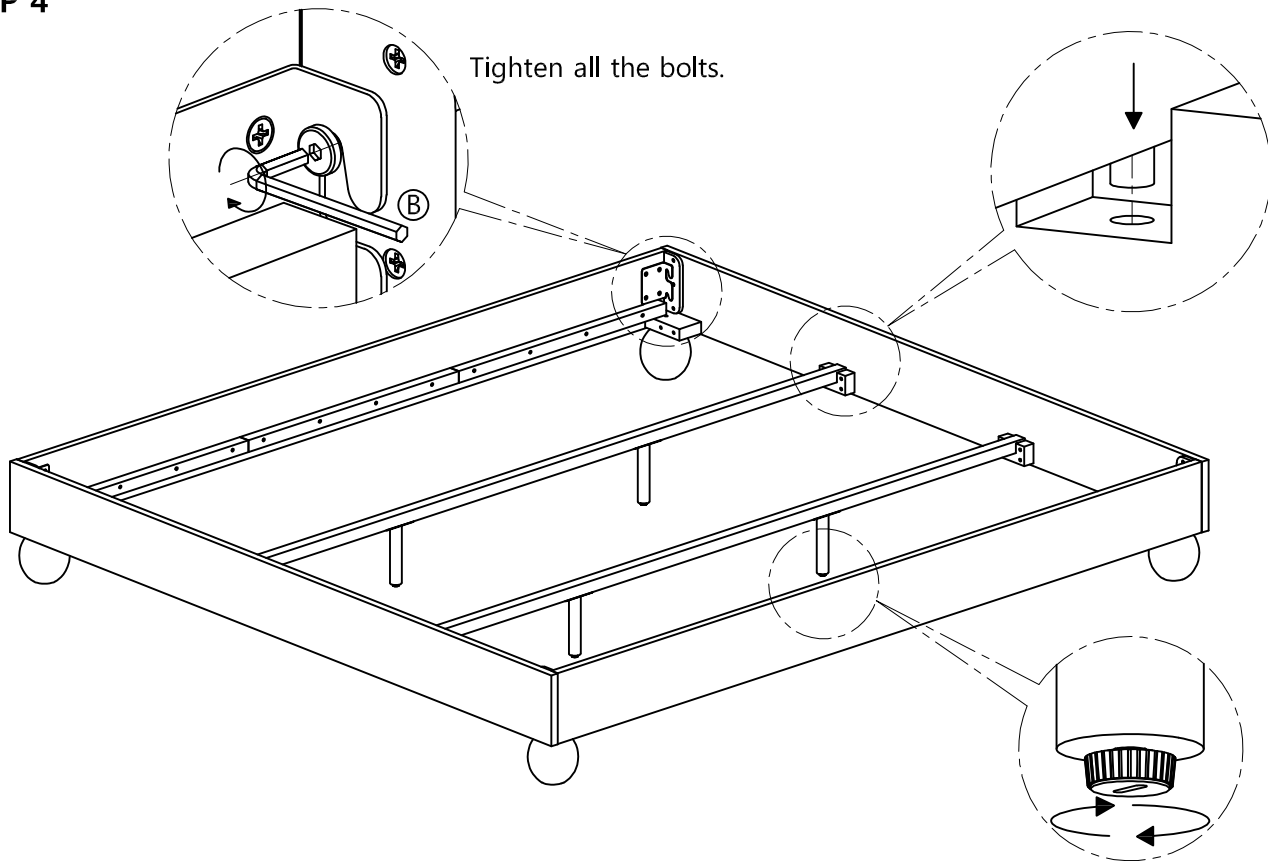

STEP 5

